

VILLAGE LOCATION



Cottage

GRANGE ROAD BIDFORD-ON-AVON, ALCESTER, B50 4BY

Per Month

£875 Per

FEATURES



AVON
ESTATES

1 Bedroom Cottage located in Alcester

Tenure Freehold

We understand the property is for sale 'Freehold'. Purchasers should obtain confirmation of this through their solicitors prior to exchange of contracts.

Council Tax Band

Currently tax band 'A' this is subject to change during the conveyance if the property has been extended since 1st April 1991

NB

Whilst we endeavour to make our sale's details accurate, if at any point there is anything of particular importance to you, please contact us and we will be pleased to check the information. Please do so if you're travelling some distance to view the property. These particulars are not to form part of the sale contract and may be subject to errors and/or omissions. The agents did not verify the property's structural integrity, ownership, tenure, acreage, planning/building regulations, status, square footage or the availability/operation of services and/or appliances. The property is sold subject to any rights-of-way, public footpaths, wayleaves, covenants and any other issues or planning/building regulation matters which may affect the legal title. Prospective purchasers must satisfy themselves as to the particulars correctness and should seek legal validation of all matters prior to expressing any formal intent to purchase. All fixtures, fittings, chattels and other items not mentioned are specifically excluded unless otherwise agreed within the sale contract. No person in this firm's employment has the authority to make or give any representation or warranty in any respect



HEAD OFFICE SALES | 7 VINE STREET, EVESHAM, WORCESTERSHIRE, WR11 4RE

01386 257180

www.avonestates.net

Council Tax Band

D

Ground Floor

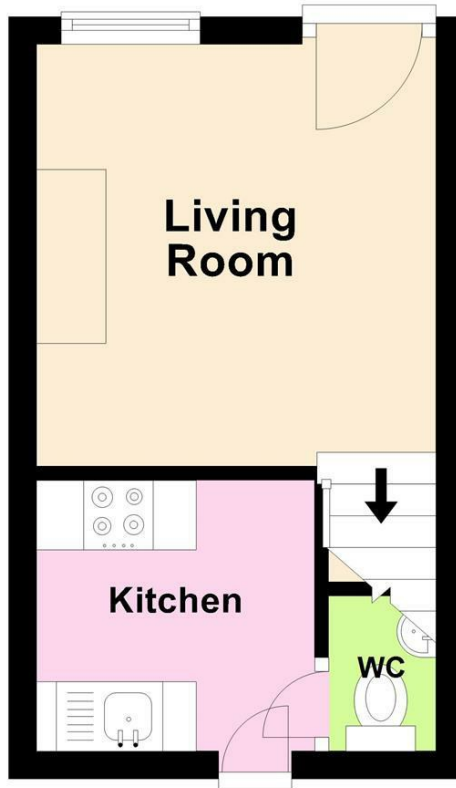

First Floor



Energy Efficiency Rating		Current	Potential
<p><i>Very energy efficient - lower running costs</i></p> <p>A (92 plus)</p> <p>B (81-91)</p> <p>C (69-80)</p> <p>D (55-68)</p> <p>E (39-54)</p> <p>F (21-38)</p> <p>G (1-20)</p> <p><i>Not energy efficient - higher running costs</i></p>		60	80
<p>England & Wales</p>		<p>EU Directive 2002/91/EC</p>	

Agents Note: Whilst every care has been taken to prepare these particulars, they are for guidance purposes only. All measurements are approximate and are for general guidance purposes only and whilst every care has been taken to ensure their accuracy, they should not be relied upon and potential buyers are advised to recheck the measurements.

AVON
ESTATES